

Rvs lasbochten

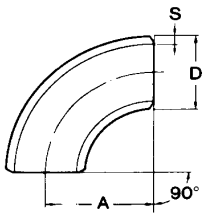

Afmeting (diam. x wanddikte)	Gewicht kg/st	Radius A	type	304/304L (1.4306) gelast	304/304L (1.4306) naadloos	316/316L (1.4404) gelast	316/316L (1.4404) naadloos
12,00 x 1,50	0,03	26,00	90°			x	
13,50 x 2,30	0,03	20,00	3S 90°				x
15,00 x 1,50	0,03	27,50	3S 90°				x
17,20 x 1,60	0,03	28,00	3S 90°	x		x	
17,20 x 2,30	0,04	28,00	3S 90°				x
18,00 x 1,50	0,03	30,00	3S 90°				x
20,00 x 1,50	0,03	30,00	3S 90°	x		x	
20,00 x 2,00	0,04	30,00	3S 90°	x		x	
21,30 x 1,60	0,03	38,10	3S 90°	x		x	
21,30 x 2,00	0,06	50,00	5S 90°			x	
21,30 x 2,60	0,10	50,00	5S 90°			x	x
21,34 x 2,11 1/2" Sch 10 S	0,06	38,10	LR 90°	x	x	x	x
21,34 x 2,11 1/2" Sch 10 S	0,03	38,10	LR 45°		x		x
21,34 x 2,77 1/2" Sch 40 S STD	0,08	38,10	LR 90°	x	x	x	x
21,34 x 2,77 1/2" Sch 40 S STD	0,04	38,10	LR 45°		x	x	x
21,34 x 3,73 1/2" Sch 80 S XS	0,10	38,10	LR 90°		x		x
21,34 x 3,73 1/2" Sch 80 S XS	0,05	38,10	LR 45°		x		x
21,34 x 4,78 1/2" Sch 160	0,12	38,10	LR 90°		x		x
23,00 x 1,50	0,04	25,00	3S 90°	x		x	
25,00 x 1,50	0,04	27,50	3S 90°	x		x	
25,00 x 2,00	0,05	27,50	3S 90°	x		x	
25,40 x 1,50	0,04	38,00	90°	x		x	
26,67 x 2,11 3/4" Sch 10 S	0,06	28,60	LR 90°	x	x	x	x
26,67 x 2,11 3/4" Sch 10 S	0,03	28,60	LR 45°	x	x		x
26,67 x 2,87 3/4" Sch 40 S STD	0,10	28,60	LR 90°	x	x	x	x
26,67 x 2,87 3/4" Sch 40 S STD	0,05	28,60	LR 45°	x	x	x	x
26,67 x 3,91 3/4" Sch 80 S XS	0,12	28,60	LR 90°		x		x
26,67 x 3,91 3/4" Sch 80 S XS	0,06	28,60	LR 45°				x
26,67 x 5,56 3/4" Sch 160	0,15	28,60	LR 90°		x		x
26,67 x 5,56 3/4" Sch 160	0,08	28,60	LR 45°				x

Rvs lasbochten

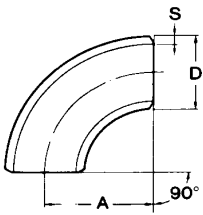

Afmeting (diam. x wanddikte)	Gewicht kg/st	Radius A	type	304/304L (1.4306) gelast	304/304L (1.4306) naadloos	316/316L (1.4404) gelast	316/316L (1.4404) naadloos
26,90 x 1,60	0,05	28,6	3S 90°	x		x	
26,90 x 2,00	0,10	57,5	5S 90°			x	
26,90 x 2,60	0,14	57,5	5S 90°				x
28,00 x 1,50	0,08	43,0	90°			x	
28,00 x 1,50	0,07	32,5	3S 90°	x		x	
28,00 x 2,00	0,07	32,5	3S 90°			x	
30,00 x 1,50	0,06	33,5	3S 90°	x			
30,00 x 2,00	0,07	33,5	3S 90°	x		x	
31,80 x 2,00	0,08	35,0	3S 90°				x
32,00 x 2,00	0,08	35,0	3S 90°	x			
33,40 x 2,77 1" Sch 10 S	0,15	38,1	LR 90°	x	x	x	x
33,40 x 2,77 1" Sch 10 S	0,08	38,1	LR 45°	x	x	x	x
33,40 x 2,77 1" Sch 10 S	0,08	25,0	SR 90°		x		x
33,40 x 3,38 1" Sch 40 S STD	0,16	38,1	LR 90°	x	x	x	x
33,40 x 3,38 1" Sch 40 S STD	0,08	38,1	LR 45°		x	x	x
33,40 x 3,38 1" Sch 40 S STD	0,10	25,0	SR 90°		x	x	x
33,40 x 4,55 1" Sch 80 S XS	0,19	38,1	LR 90°		x		x
33,40 x 4,55 1" Sch 80 S XS	0,10	38,1	LR 45°		x		x
33,40 x 6,35 1" Sch 160	0,27	38,1	LR 90°		x		x
33,40 x 6,35 1" Sch 160	0,19	38,1	LR 45°				x
33,70 x 1,60	0,08	38,1	3S 90°	x		x	
33,70 x 2,00	0,10	38,1	3S 90°	x		x	
33,70 x 2,00	0,18	72,5	5S 90°			x	
33,70 x 3,20	0,28	72,5	5S 90°				x
34,00 x 1,50	0,08	52,0	90°	x			
35,00 x 1,50	0,10	45,0	3S 90°			x	
38,00 x 1,50	0,11	45,0	3S 90°	x		x	
38,00 x 2,00	0,13	45,0	3S 90°	x		x	
38,10 x 1,50	0,11	56,0	90°	x		x	
40,00 x 1,50	0,12	60,0	90°			x	
40,00 x 1,50	0,12	45,0	3S 90°	x			

Rvs lasbochten

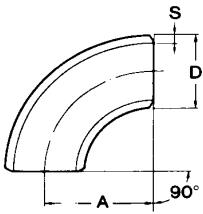

Afmeting (diam. x wanddikte)	Gewicht kg/st	Radius A	type	304/304L (1.4306) gelast	304/304L (1.4306) naadloos	316/316L (1.4404) gelast	316/316L (1.4404) naadloos
40,00 x 2,00	0,16	45,0	3S 90°	x		x	
42,16 x 2,77 1.1/4" Sch 10 S	0,20	47,6	LR 90°	x	x	x	x
42,16 x 2,77 1.1/4" Sch 10 S	0,11	47,6	LR 45°			x	x
42,16 x 3,56 1.1/4" Sch 40 S STD	0,25	47,6	LR 90°	x	x	x	x
42,16 x 3,56 1.1/4" Sch 40 S STD	0,13	47,6	LR 45°		x	x	
42,16 x 3,56 1.1/4" Sch 40 S STD	0,17	32,0	SR 90°			x	
42,16 x 4,85 1.1/4" Sch 80 XS	0,33	47,6	LR 90°		x		x
42,40 x 1,60	0,14	47,6	3S 90°	x		x	
42,40 x 2,00	0,16	47,6	3S 90°	x		x	
42,40 x 2,00	0,29	92,5	5S 90°	x		x	
42,40 x 3,20	0,53	92,5	5S 90°				x
44,50 x 2,00	0,17	51,0	3S 90°	x		x	
44,50 x 2,00	0,35	100,0	5S 90°			x	x
48,26 x 2,77 1.1/2" Sch 10 S	0,28	57,2	LR 90°	x	x	x	x
48,26 x 2,77 1.1/2" Sch 10 S	0,14	57,2	LR 45°	x	x	x	x
48,26 x 2,77 1.1/2" Sch 10 S	0,19	38,0	SR 90°				x
48,26 x 3,68 1.1/2" Sch 40 S STD	0,36	57,2	LR 90°	x	x	x	x
48,26 x 3,68 1.1/2" Sch 40 S STD	0,18	57,2	LR 45°		x	x	x
48,26 x 3,68 1.1/2" Sch 40 S STD	0,25	38,0	SR 90°		x	x	
48,26 x 5,08 1.1/2" Sch 80 S XS	0,49	57,2	LR 90°		x		x
48,26 x 5,08 1.1/2" Sch 80 S XS	0,25	57,2	LR 45°		x		x
48,26 x 7,14 1.1/2" Sch 160	0,68	57,2	LR 90°		x		x
48,30 x 1,60	0,19	57,2	3S 90°	x		x	
48,30 x 2,00	0,22	57,2	3S 90°	x		x	
48,30 x 2,00	0,40	110,0	5S 90°	x		x	
48,30 x 3,20	0,64	110,0	5S 90°				x
50,80 x 1,50	0,25	72,0	90°	x		x	
51,00 x 1,50	0,25	67,5	3S 90°	x		x	
51,00 x 2,00	0,31	67,5	3S 90°	x		x	
51,00 x 2,60	0,35	67,5	3S 90°				x
52,00 x 1,50	0,25	72,0	90°			x	
53,00 x 1,50	0,26	72,5	3S 90°	x		x	

Rvs lasbochten

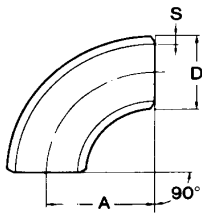

Afmeting (diam. x wanddikte)	Gewicht kg/st	Radius A	type	304/304L (1.4306) gelast	304/304L (1.4306) naadloos	316/316L (1.4404) gelast	316/316L (1.4404) naadloos
54,00 x 2,00	0,34	72,5	3S 90°	x		x	
57,00 x 2,00	0,34	75,0	3S 90°	x		x	
57,00 x 3,00	0,48	75,0	3S 90°	x		x	
60,30 x 1,60	0,29	76,2	3S 90°	x		x	
60,30 x 2,00	0,34	76,2	3S 90°	x		x	
60,30 x 2,00	0,60	135,0	5S 90°			x	
60,30 x 3,60	1,10	135,0	5S 90°				x
60,33 x 2,77 2" Sch 10 S	0,47	76,2	LR 90°	x	x	x	x
60,33 x 2,77 2" Sch 10 S	0,24	76,2	LR 45°		x	x	x
60,33 x 2,77 2" Sch 10 S	0,32	51,0	SR 90°	x	x	x	x
60,33 x 3,91 2" Sch 40 S STD	0,65	76,2	LR 90°	x	x	x	x
60,33 x 3,91 2" Sch 40 S STD	0,33	76,2	LR 45°	x	x	x	x
60,33 x 3,91 2" Sch 40 S STD	0,45	51,0	SR 90°		x	x	x
60,33 x 5,54 2" Sch 80 S XS	0,89	76,2	LR 90°		x		x
60,33 x 5,54 2" Sch 80 S XS	0,45	76,2	LR 45°		x		x
60,33 x 8,74 2" Sch 160	1,40	76,2	LR 90°		x		x
60,33 x 8,74 2" Sch 160	0,70	76,2	LR 45°		x		x
63,50 x 1,50	0,33	84,0	90°	x			
63,50 x 1,60	0,33	82,5	3S 90°	x		x	
63,50 x 2,00	0,37	82,5	3S 90°	x		x	
70,00 x 2,00	0,50	85,0	90°			x	
70,00 x 2,00	0,50	92,0	3S 90°	x		x	
70,00 x 2,00	0,88	160,0	5S 90°			x	
70,00 x 3,00	0,72	92,0	3S 90°	x			
73,03 x 3,05 2.1/2" Sch 10 S	0,79	95,3	LR 90°	x	x	x	x
73,03 x 3,05 2.1/2" Sch 10 S	0,40	95,3	LR 45°		x	x	
73,03 x 5,16 2.1/2" Sch 40 S STD	1,29	95,3	LR 90°	x	x	x	x
73,03 x 5,16 2.1/2" Sch 40 S STD	0,65	95,3	LR 45°		x	x	
73,03 x 5,16 2.1/2" Sch 40 S STD	0,87	63,0	SR 90°			x	
73,03 x 7,01 2.1/2" Sch 80 S XS	1,70	95,3	LR 90°				x
76,10 x 1,60	0,50	95,3	3S 90°	x		x	
76,10 x 2,00	0,62	85,0	90°			x	
76,10 x 2,00	0,62	95,3	3S 90°	x		x	
76,10 x 2,00	1,00	175,0	5S 90°			x	
76,10 x 2,00	1,29	175,0	5S 90°			x	

Rvs lasbochten

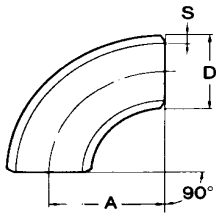

Afmeting (diam. x wanddikte)	Gewicht kg/st	Radius A	type	304/304L (1.4306) gelast	304/304L (1.4306) naadloos	316/316L (1.4404) gelast	316/316L (1.4404) naadloos
76,10 x 3,00	0,90	95,3	3S 90°	x		x	
76,10 x 3,60	1,08	95,3	3S 90°	x		x	
84,00 x 2,00	0,75	120,0	3S 90°	x		x	
84,00 x 2,00	1,35	200,0	5S 90°			x	
85,00 x 2,00	0,75	93,0	90°			x	
88,90 x 2,00	0,81	114,3	3S 90°	x		x	
88,90 x 2,00	1,39	205,0	5S 90°			x	
88,90 x 2,60	1,80	205,0	5S 90°			x	
88,90 x 3,05 3" Sch 10 S	1,16	114,3	LR 90°	x	x	x	x
88,90 x 3,05 3" Sch 10 S	0,63	114,3	LR 45°	x	x	x	x
88,90 x 3,05 3" Sch 10 S	0,77	76,0	SR 90°		x	x	x
88,90 x 4,00	1,65	114,5	3S 90°	x		x	
88,90 x 5,49 3" Sch 40 S STD	2,02	114,3	LR 90°	x	x	x	x
88,90 x 5,49 3" Sch 40 S STD	1,01	114,3	LR 45°	x	x	x	x
88,90 x 5,49 3" Sch 40 S STD	1,38	76,0	SR 90°		x	x	x
88,90 x 7,62 3" Sch 80 S XS	2,74	114,3	LR 90°		x		x
88,90 x 7,62 3" Sch 80 S XS	1,37	114,3	LR 45°		x		x
88,90 x 11,13 3" Sch 160	4,02	114,3	LR 90°				x
101,60 x 2,00	1,05	133,4	3S 90°	x		x	
101,60 x 3,05 3.1/2" Sch 10 S	1,56	133,4	LR 90°	x		x	
101,60 x 5,74 3.1/2" Sch 40 S STD	2,84	133,4	LR 90°		x		x
104,00 x 2,00	1,20	150,0	3S 90°	x		x	
104,00 x 2,00	2,50	250,0	5S 90°			x	
104,00 x 2,00	1,61	200,0	D+100 90°	x		x	
106,00 x 3,00	2,40	200,0	D+100 90°		x	x	
108,00 x 2,00	1,10	142,5	3S 90°	x	x	x	
108,00 x 4,00	2,20	142,5	3S 90°	x	x	x	
114,30 x 2,00	1,20	152,4	3S 90°	x		x	
114,30 x 2,60	3,00	270,0	5S 90°			x	
114,30 x 3,05 4" Sch 10 S	2,00	152,4	LR 90°	x	x	x	x
114,30 x 3,05 4" Sch 10 S	1,00	152,4	LR 45°	x	x	x	x
114,30 x 3,05 4" Sch 10 S	1,33	102,0	SR 90°	x	x	x	x
114,30 x 4,00	4,00	152,4	3S 90°	x		x	
114,30 x 6,02 4" Sch 40 S STD	3,84	152,4	LR 90°	x	x	x	x

Rvs lasbochten

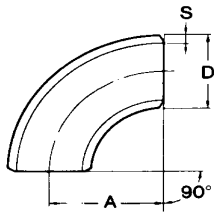

Afmeting	Gewicht	Radius	type	304/304L	304/304L	316/316L	316/316L
(diam. x wanddikte)	kg/st	A		(1.4306)	(1.4306)	(1.4404)	(1.4404)
				gelast	naadloos	gelast	naadloos
114,30 x 6,02	1,92	152,4	LR	45°	x	x	x
114,30 x 6,02	2,62	102,0	SR	90°	x	x	x
114,30 x 8,56	5,34	152,4	LR	90°		x	x
114,30 x 13,49	8,42	152,4	LR	90°		x	
129,00 x 2,00	2,00	187,5	3S	90°	x		x
129,00 x 2,00	1,00	187,5	3S	45°			x
129,00 x 2,00	3,10	312,5	5S	90°			x
129,00 x 2,00	2,20	225,0	D+100	90°	x		
133,00 x 4,00	3,64	181,0	3S	90°	x		x
139,70 x 2,00	2,07	190,5	3S	90°	x		x
139,70 x 2,60	4,30	330,0	5S	90°	x		x
139,70 x 3,00	3,08	190,5	3S	90°	x		x
139,70 x 4,00	4,10	190,5	3S	90°	x		x
141,30 x 3,40	3,46	190,5	LR	90°	x	x	x
141,30 x 3,40	1,73	190,5	LR	45°		x	x
141,30 x 6,55	6,51	190,5	LR	90°	x	x	x
141,30 x 6,55	3,26	190,5	LR	45°		x	
154,00 x 2,00	2,60	225,0	3S	90°	x		x
154,00 x 2,00	4,40	375,0	5S	90°			x
154,00 x 2,00	3,00	250,0	D+100	90°	x		x
156,00 x 3,00	4,50	250,0	D+100	90°			x
159,00 x 3,00	3,95	216,0	3S	90°	x		
159,00 x 4,00	5,23	216,0	3S	90°	x		x
168,28 x 3,40	4,96	228,6	LR	90°	x	x	x
168,28 x 3,40	2,48	228,6	LR	45°	x	x	x
168,28 x 3,40	3,29	152,0	SR	90°	x		x
168,28 x 7,11	10,10	228,6	LR	90°	x	x	x
168,28 x 7,11	5,05	228,6	LR	45°	x	x	x
168,28 x 7,11	6,89	152,0	SR	90°			x
168,28 x 10,97	15,30	228,6	LR	90°		x	x
168,28 x 10,97	7,65	228,6	LR	45°		x	x
168,30 x 2,00	3,00	228,5	3S	90°	x		x
168,30 x 2,60	6,05	390,0	5S	90°			x

Rvs lasbochten

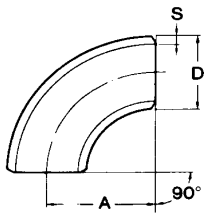

Afmeting (diam. x wanddikte)	Gewicht kg/st	Radius A	type	304/304L (1.4306) gelast	304/304L (1.4306) naadloos	316/316L (1.4404) gelast	316/316L (1.4404) naadloos
168,30 x 3,00	4,56	228,5	3S 90°	x		x	
168,30 x 4,00	5,90	228,6	3S 90°	x			
204,00 x 2,00	4,80	300,0	D+100 90°	x		x	
204,00 x 2,00	7,95	500,0	5S 90°			x	
206,00 x 3,00	7,30	300,0	D+100 90°	x		x	
219,08 x 3,76 8" Sch 10 S	9,55	304,8	LR 90°	x	x	x	x
219,08 x 3,76 8" Sch 10 S	4,78	304,8	LR 45°	x		x	x
219,08 x 3,76 8" Sch 10 S	6,34	203,0	SR 90°	x		x	
219,08 x 8,18 8" Sch 40 S STD	20,30	304,8	LR 90°	x	x	x	x
219,08 x 8,18 8" Sch 40 S STD	10,15	304,8	LR 45°		x	x	x
219,08 x 8,18 8" Sch 40 S STD	13,80	203,0	SR 90°	x	x	x	x
219,08 x 12,70 8" Sch 80 S XS	30,90	304,8	LR 90°		x		x
219,10 x 2,00	5,23	305,0	3S 90°	x		x	
219,10 x 3,00	7,80	305,0	3S 90°	x		x	
219,10 x 3,00	13,30	510,0	5S 90°			x	
219,10 x 4,00	10,00	305,0	3S 90°	x		x	
254,00 x 2,00	7,00	350,0	D+100 90°	x		x	
254,00 x 2,00	3,50	350,0	D+100 45°			x	
256,00 x 3,00	10,50	350,0	D+100 90°	x		x	
273,00 x 2,00	8,10	381,0	3S 90°	x		x	
273,00 x 2,50	10,17	381,0	3S 90°	x			
273,00 x 3,00	12,34	381,0	3S 90°	x		x	
273,05 x 4,19 10" Sch 10 S	16,60	381,0	LR 90°	x		x	
273,05 x 4,19 10" Sch 10 S	8,30	381,0	LR 45°	x		x	
273,05 x 4,19 10" Sch 10 S	11,07	254,0	SR 90°			x	
273,05 x 9,27 10" Sch 40 S STD	36,00	381,0	LR 90°	x	x	x	x
273,05 x 9,27 10" Sch 40 S STD	18,00	381,0	LR 45°	x		x	
304,00 x 2,00	10,00	400,0	D+100 90°	x		x	
306,00 x 3,00	16,20	457,0	3S 90°	x		x	
306,00 x 3,00	14,40	400,0	D+100 90°	x		x	
323,85 x 4,57 12" Sch 10 S	25,80	457,2	LR 90°	x		x	

Rvs lasbochten

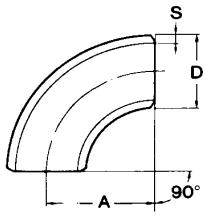

Afmeting (diam. x wanddikte)	Gewicht kg/st	Radius A	type	304/304L (1.4306) gelast	304/304L (1.4306) naadloos	316/316L (1.4404) gelast	316/316L (1.4404) naadloos
323,85 x 4,57 12" Sch 10 S	12,90	457,2	LR 45°	x		x	
323,85 x 4,57 12" Sch 10 S	17,31	305,0	SR 90°	x			
323,85 x 9,53 12" Sch 40 S STD	53,00	457,2	LR 90°	x		x	x
323,85 x 9,53 12" Sch 40 S STD	26,50	457,2	LR 45°	x		x	
323,90 x 2,00	16,50	457,0	3S 90°	x			
323,90 x 3,00	17,37	457,0	3S 90°	x		x	
355,60 x 4,78 14" Sch 10 S	34,60	533,4	LR 90°	x		x	
355,60 x 4,78 14" Sch 10 S	17,30	533,4	LR 45°	x			
355,60 x 4,78 14" Sch 10 S	23,22	356,0	SR 90°	x			
355,60 x 4,78 14" Sch 10 S	11,61	356,0	SR 45°	x			
356,00 x 3,00	21,90	533,4	3S 90°	x		x	
356,00 x 3,00	18,80	450,0	D+100 90°	x		x	
406,00 x 3,00	24,00	500,0	D+100 90°	x		x	
406,40 x 3,00	28,80	609,6	3S 90°	x		x	
406,40 x 4,78 16" Sch 10 S	45,20	609,6	LR 90°	x		x	
406,40 x 4,78 16" Sch 10 S	22,60	609,6	LR 45°	x		x	
406,40 x 4,78 16" Sch 10 S	23,22	406,0	SR 90°	x			
406,40 x 4,78 16" Sch 10 S	11,61	406,0	SR 45°	x			
406,40 x 9,53 16" Sch 40 S STD	89,20	609,6	LR 90°			x	
456,00 x 3,00	30,00	550,0	D+100 90°	x		x	
457,20 x 4,78 18" Sch 10 S	57,30	685,8	LR 90°	x		x	
506,00 x 3,00	37,00	600,0	D+100 90°	x		x	
508,00 x 5,56 20" Sch 10 S	82,00	762,0	LR 90°	x		x	
508,00 x 5,56 20" Sch 10 S	41,00	762,0	LR 45°	x			
606,00 x 3,00	49,00	700,0	D+100 90°	x		x	
609,00 x 6,35 24" Sch 10/Sch 10 S	136,00	914,0	LR 90°	x		x	